

# Calibration can be completed in just 6 steps

1. IN TECHPRO® SELECT MAKER - MODEL. THEN SELECT "DIGITAL ADAS": THE ON-LINE HELP POPS UP, WITH INSTRUCTIONS ON HOW THE CAR SHOULD BE POSITIONED.



2. PLACE THE WHEEL CLAMPS ON THE FRONT WHEELS, AS INDICATED IN THE ON-LINE HELP INSTRUCTIONS.



3. PLACE THE DIGITAL TARGET CLOSE TO THE CAR: THE SPECIAL SUPPORT FRAME MAKES HANDLING EXTREMELY EASY.

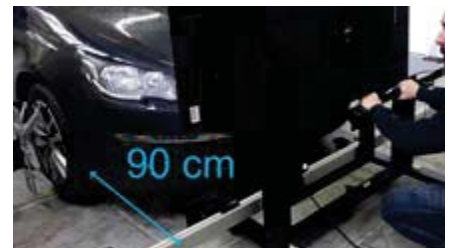

4. ENTER THE REQUIRED VALUES, USING THE TWO LASER DISTANCE METERS. THESE ARE THE PARAMETERS REQUIRED TO EXECUTE THE KEYSTONE FUNCTION.

5. ADJUST THE HEIGHT AS INDICATED IN THE ON-LINE HELP INSTRUCTIONS. IT'S VERY SIMPLE AND EASY VIA THE REMOTE CONTROL AND THE MOTORIZED SLIDING CARRIAGE.

6. THE CALIBRATION STARTS. THE MONITOR WILL SHOW THE TARGET ADAPTING IT TO THE CAR POSITION, AND THEREFORE ENSURING THE MOST ACCURATE RESULT.

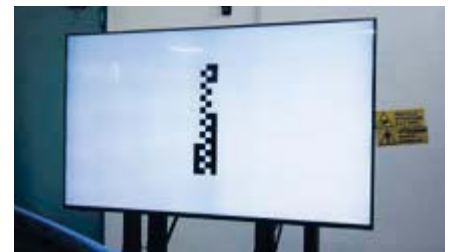
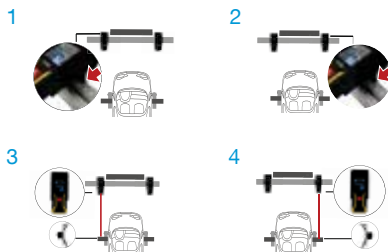

## FULLY AUTOMATIC

The calibration frame is adjusted automatically, through the electric control, and any movement of the target in relation to the car, is automatic and virtual. The car never moves!

## KEYSTONE SYSTEM

Extreme accuracy is guaranteed by the self-adaptive system, which allows the software to evaluate the environmental and physical conditions (floor, distance from vehicle) and adapt the digital target image accordingly.

## UNIVERSAL COVERAGE

Ensuring the largest market coverage is very important to us. The database that is behind the operation of TechPRO® Digital ADAS follows the constant development of TechPRO® self-diagnosis.